

Assembly instructions

Noa Metal Bed

[120 x 190]

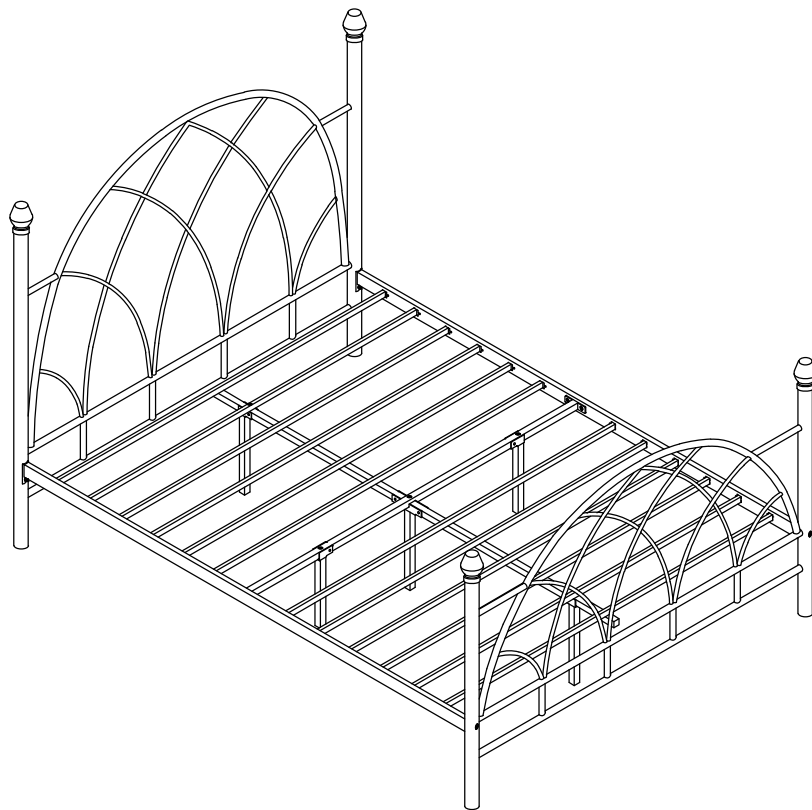

IMPORTANT

1. PLEASE CHECK THAT ALL PARTS ARE PRESENT BEFORE YOU START THE ASSEMBLY OF YOUR FURNITURE.
2. FOR THE PROTECTION OF YOUR FURNITURE, PLACE ALL PARTS ON A CLEAN AND SMOOTH SURFACE TO PREVENT ANY DAMAGE.
3. PLEASE PERIODICALLY CHECK ALL FITTINGS AND RE-TIGHTEN AS NECESSARY.

PART LIST

① Headboard x 1pc

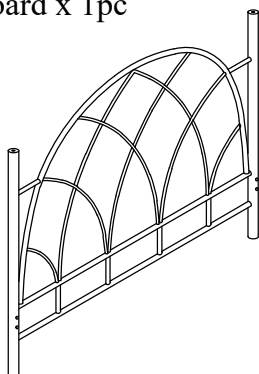

② Footboard x 1pc

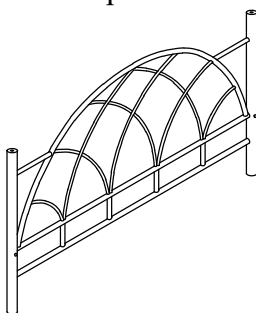

③ Side Rail x 2pcs

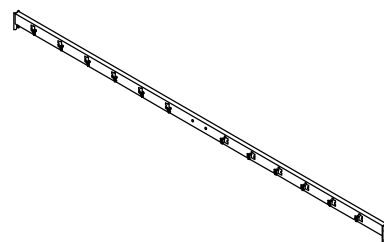

④ x 1pc

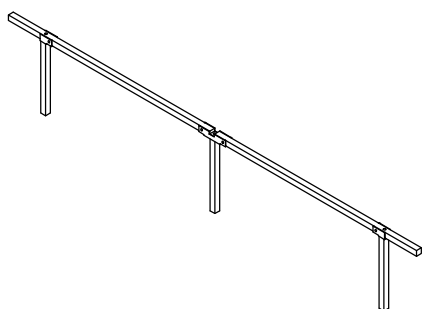

⑤ x 1pc

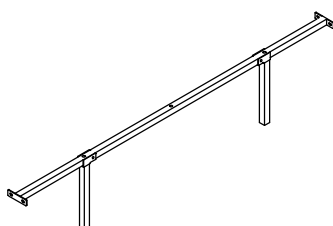

⑥ x 2pc

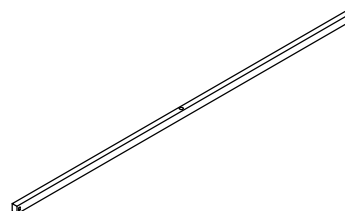

⑦ x 10pcs

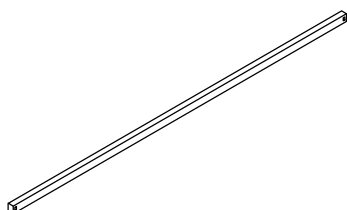

⑧ x 4pcs

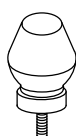

HARDWARE LIST

(A) Bolt M6 x 15mm x 8pcs



(B) Bolt M6 x 60mm x 4pcs



(C) Bolt M8 x 40mm x 2pcs

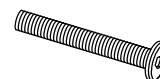

(D) Bolt M8 x 60mm x 3pcs



(E) M6 x 4pcs



(F) M6 x 4pcs



(G) M6 x 4pcs



(H) M4 x 1pc



(I) M5 x 1pc



STEP 1

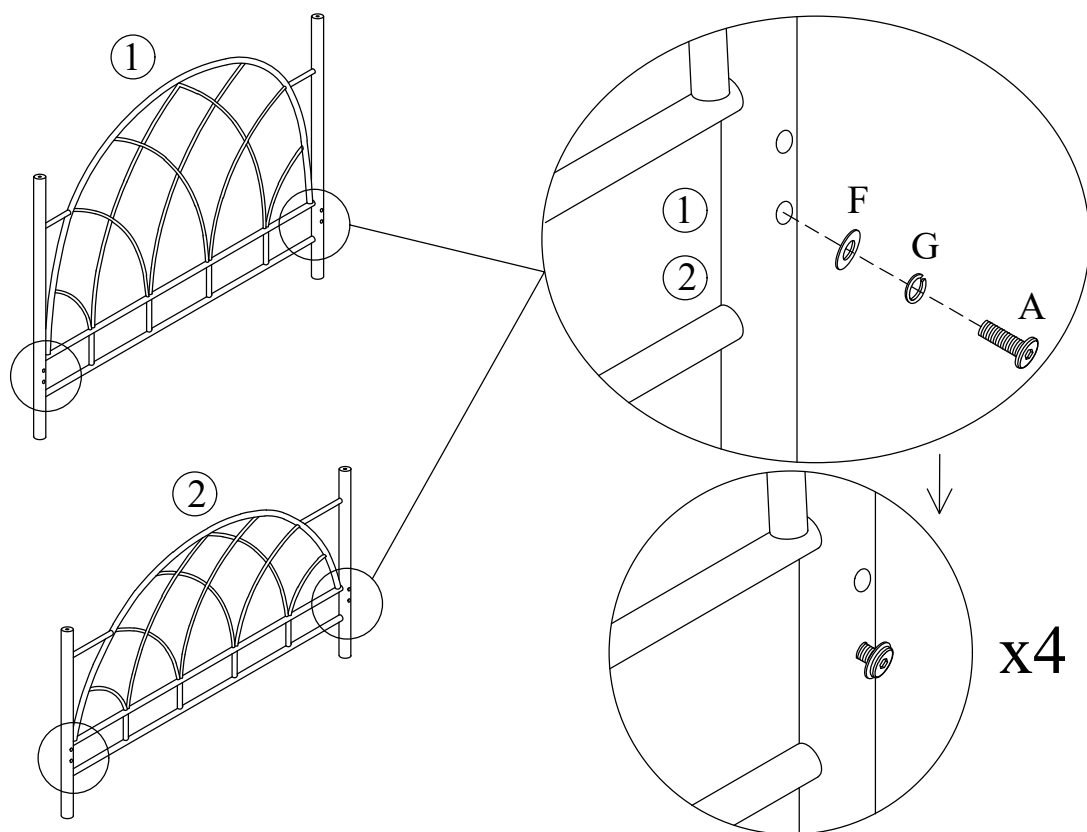

STEP 2

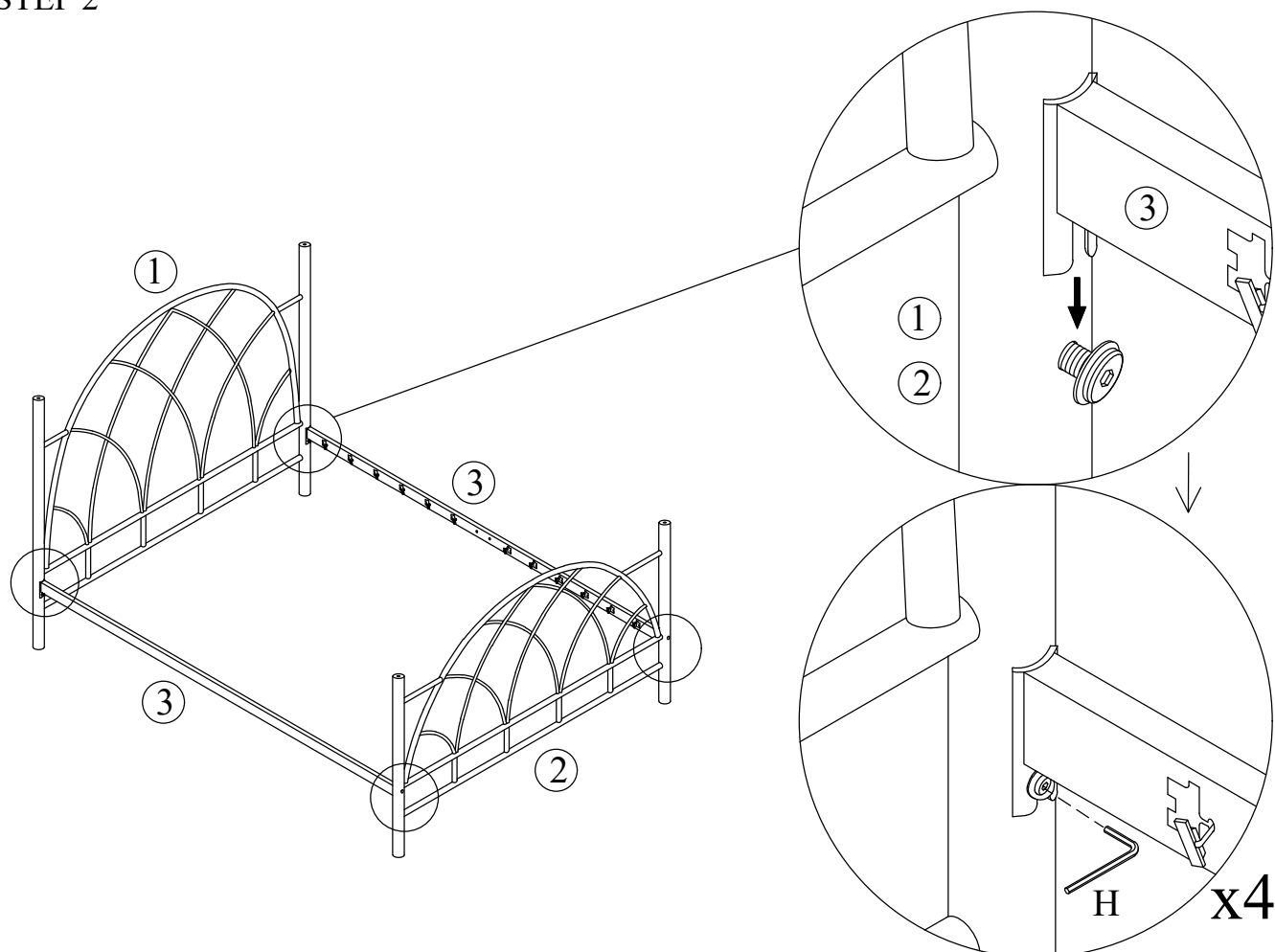

STEP 3

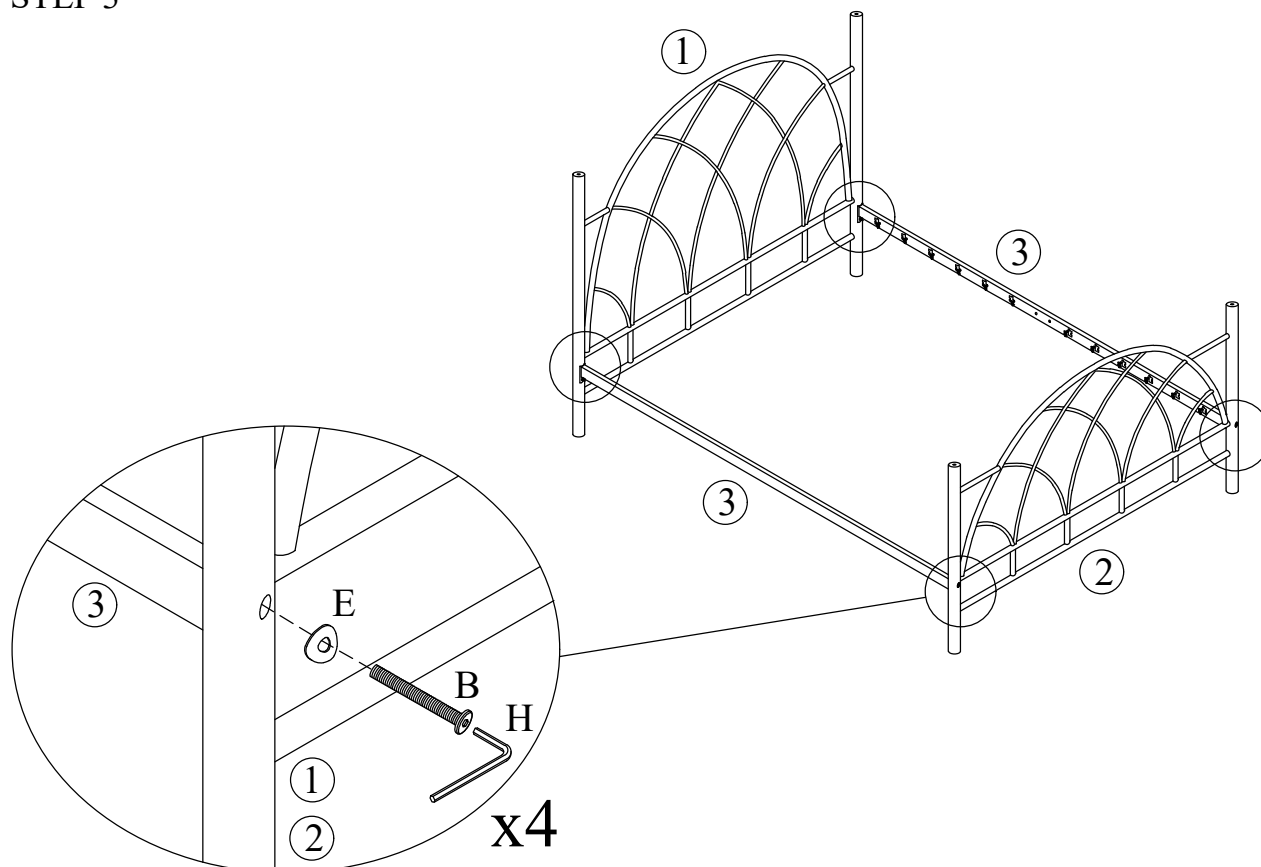

STEP 4

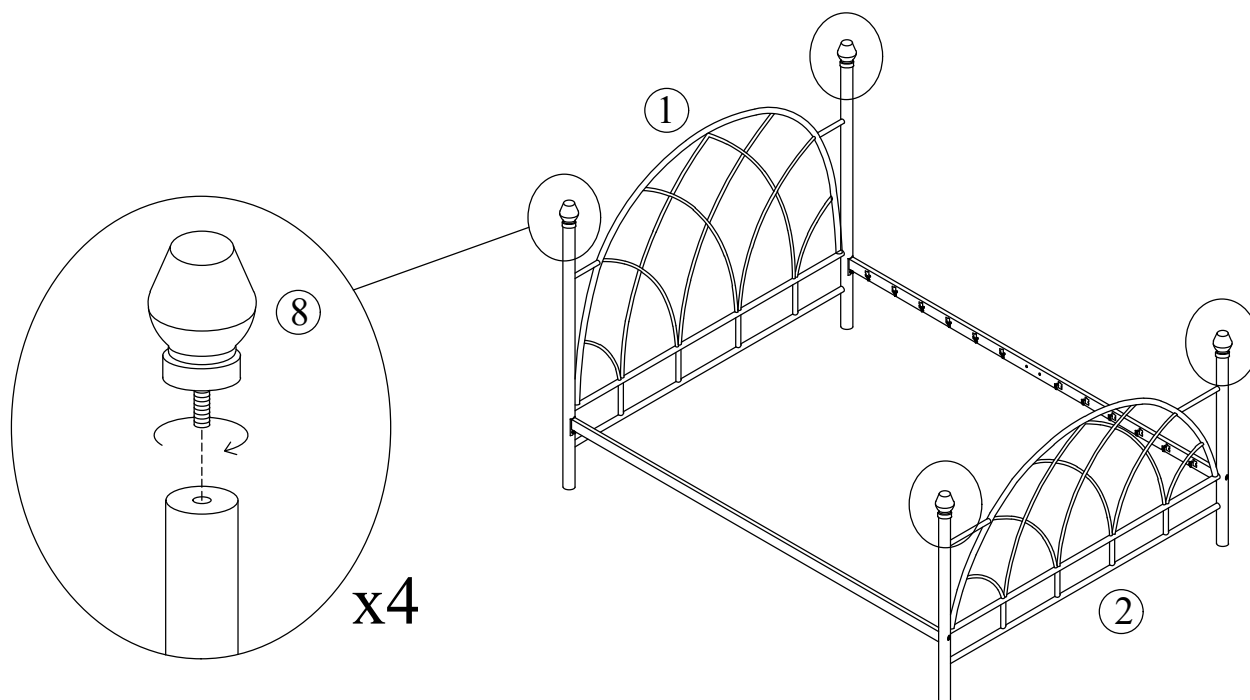

STEP 5

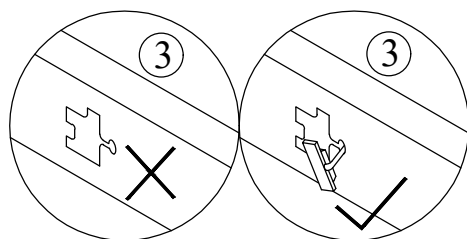

Before assembling the mattress tube, please check whether the plastic clip is fastened on the bed beam, as shown in the picture, please fasten it by hand.

Note: 1. Please insert one end of part ⑥ into the **bottom** of part ③.
2. Then the other end of part ⑥ can be inserted into another part ③.

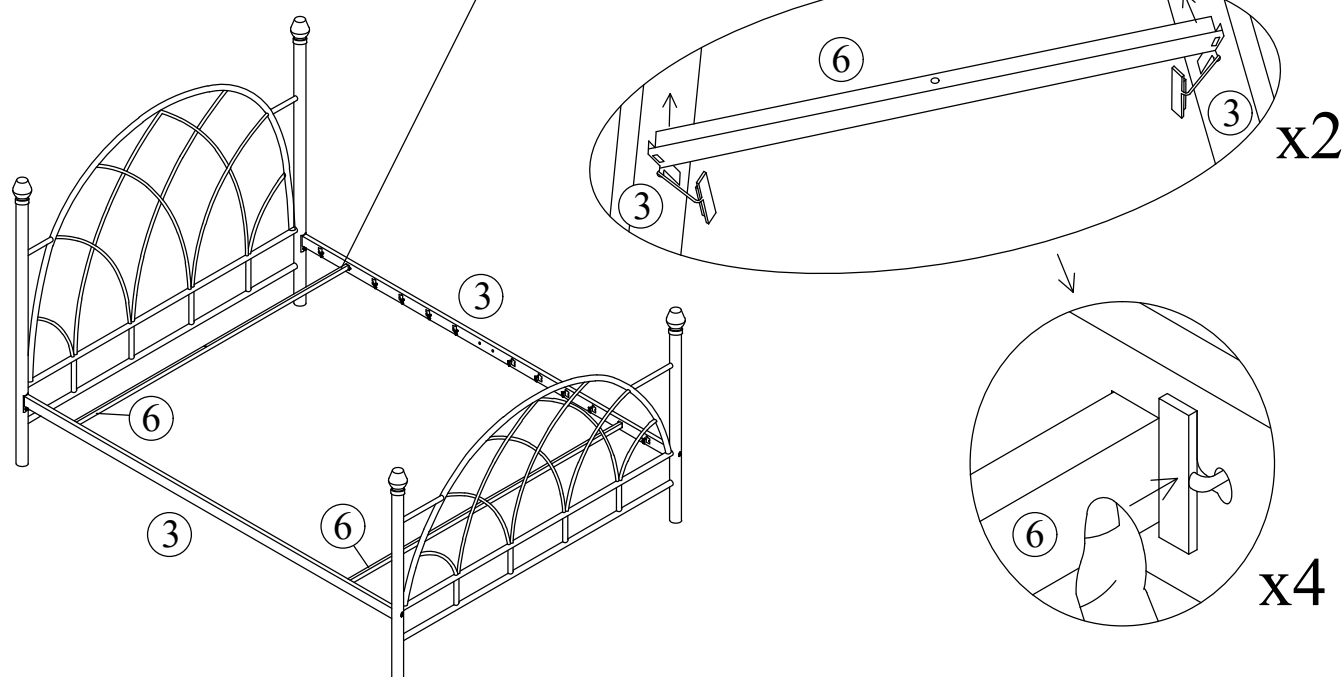

STEP 6

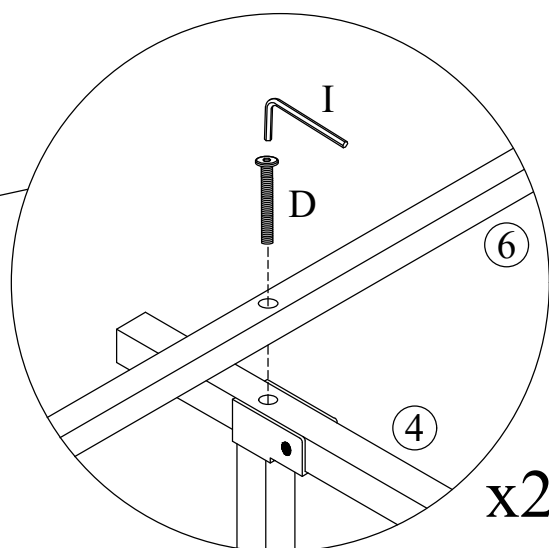
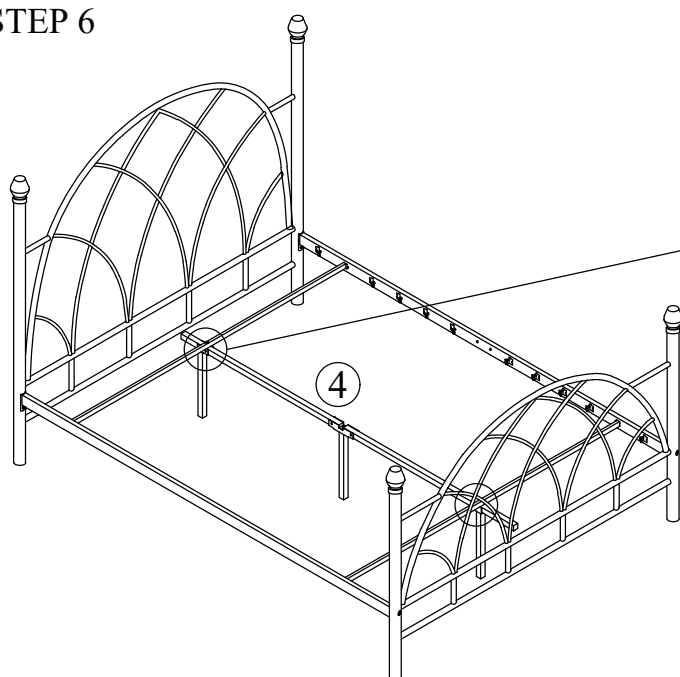

STEP 7

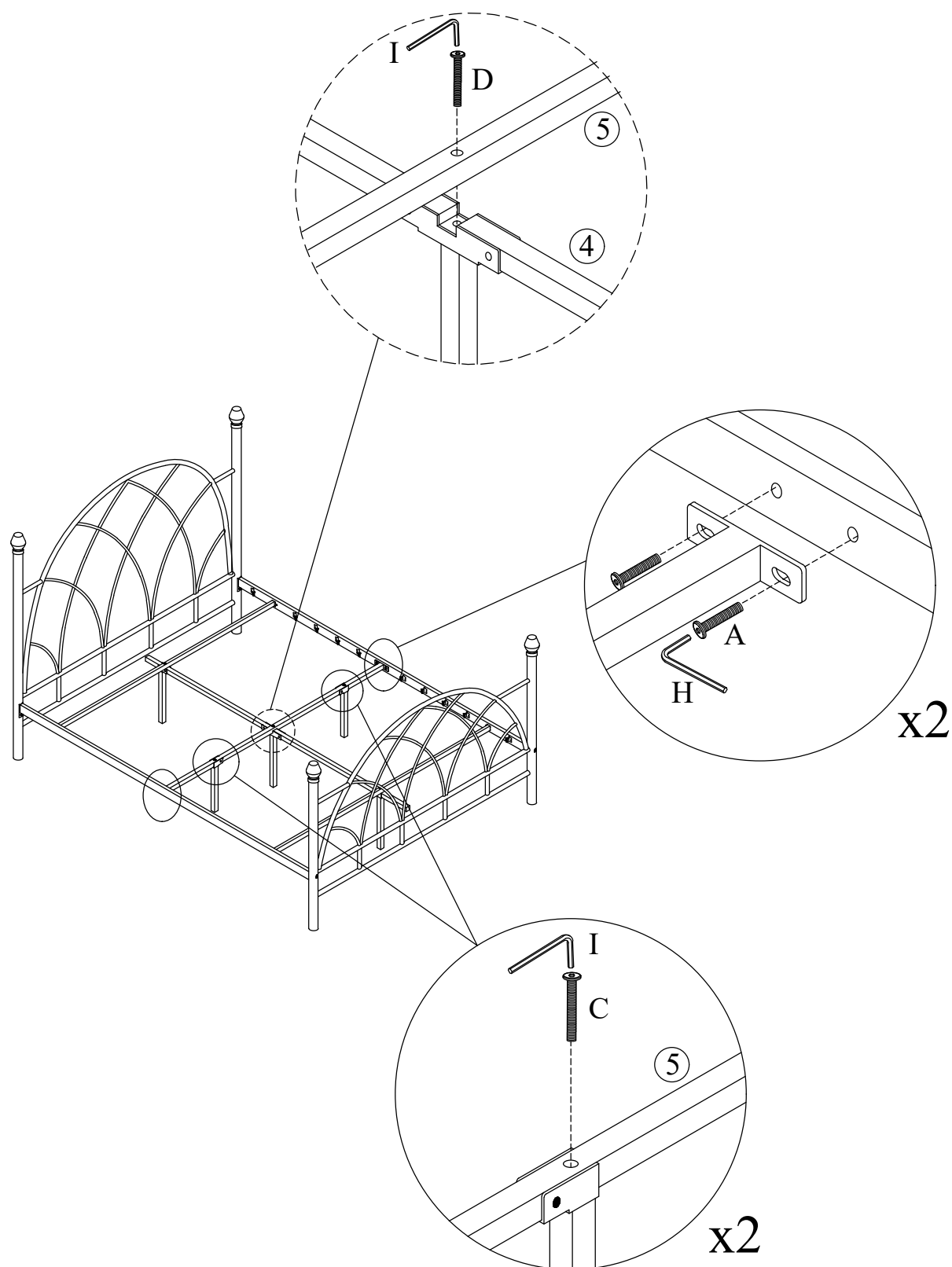

STEP 8

- Note:** 1. Please insert one end of part ⑦ into the **bottom** of part ③.
2. Then the other end of part ⑦ can be inserted into another part ③.

