

# Assembly instructions

## Base without storage

[120 x 190]

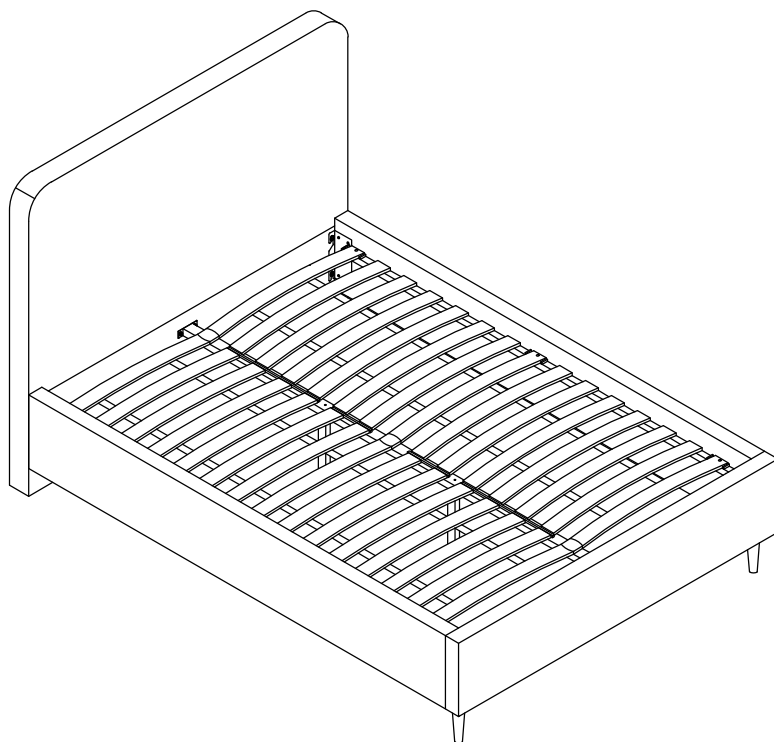

### IMPORTANT

1. PLEASE CHECK THAT ALL PARTS ARE PRESENT BEFORE YOU START THE ASSEMBLY OF YOUR FURNITURE.
2. FOR THE PROTECTION OF YOUR FURNITURE, PLACE ALL PARTS ON A CLEAN AND SMOOTH SURFACE TO PREVENT ANY DAMAGE.
3. PLEASE PERIODICALLY CHECK ALL FITTINGS AND RE-TIGHTEN AS NECESSARY.

## PART LIST

(1) Headboard x 1pc

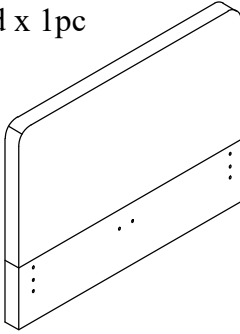

(2) Footboard x 1pc

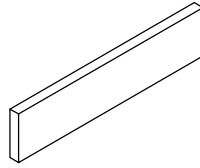

(3) Slats x 2pcs

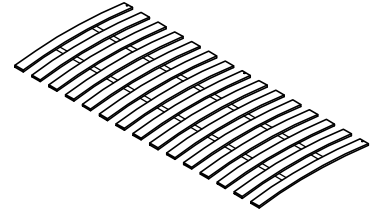

(4) Side Rail (Left) x 1pc

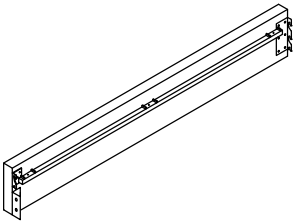

(5) Side Rail (Right) x 1pc

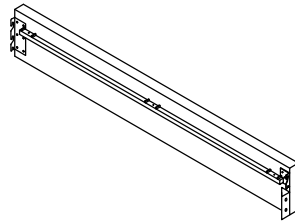

(6) Legs x 2pcs



(7) Centre Support Bar x 1pc

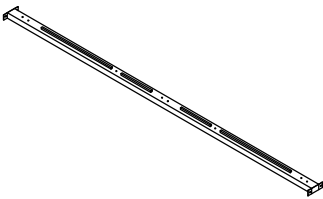

(8) Centre Support Bar Legs  
x 2pcs



(9) Slat centre cap x 3pcs



## HARDWARE LIST

(A) Bolt M8 x 25mm x 18pcs

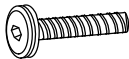

(B) Slat Pin x 6pcs



(C) Spring Washer x 16pcs



(D) Flat Washer x 22pcs



(E) Allen Key M5 x 1pc



(F) Spanner x 1pc

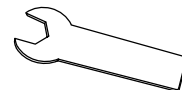

(G) Nut M8 x 13mm x 2pcs



(H) Bolt M8 x 45mm x 2pcs

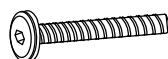

## STEP 1

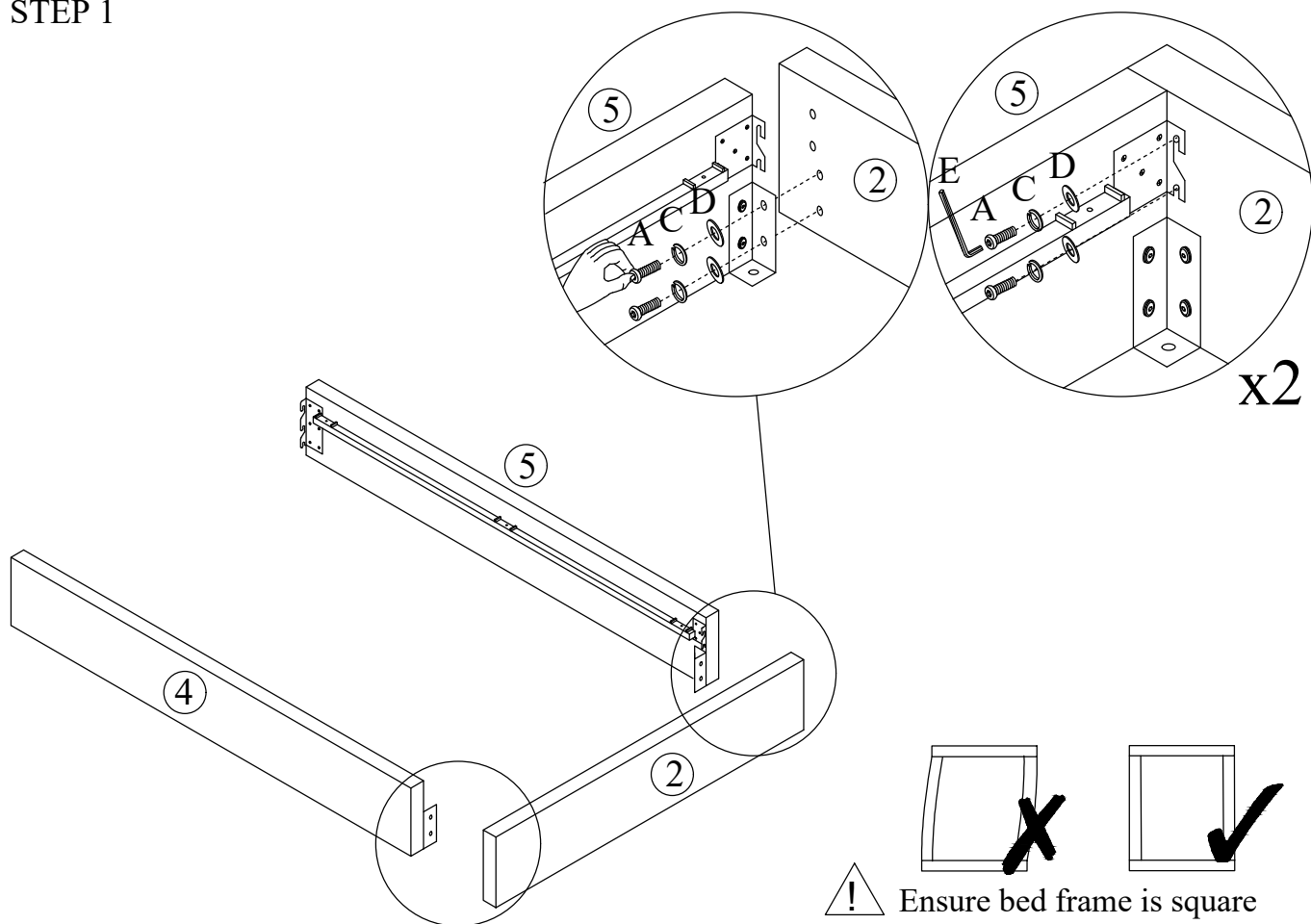

## STEP 2

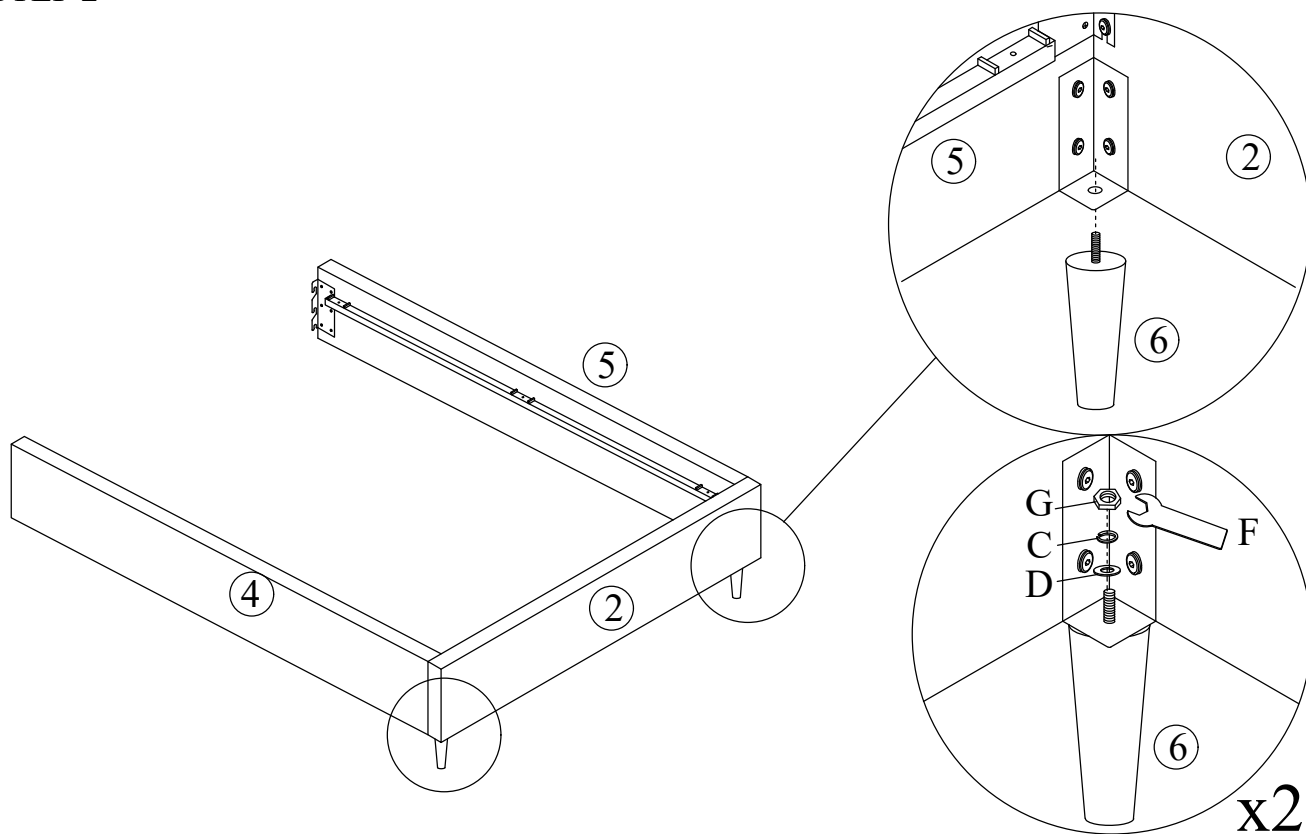

### STEP 3

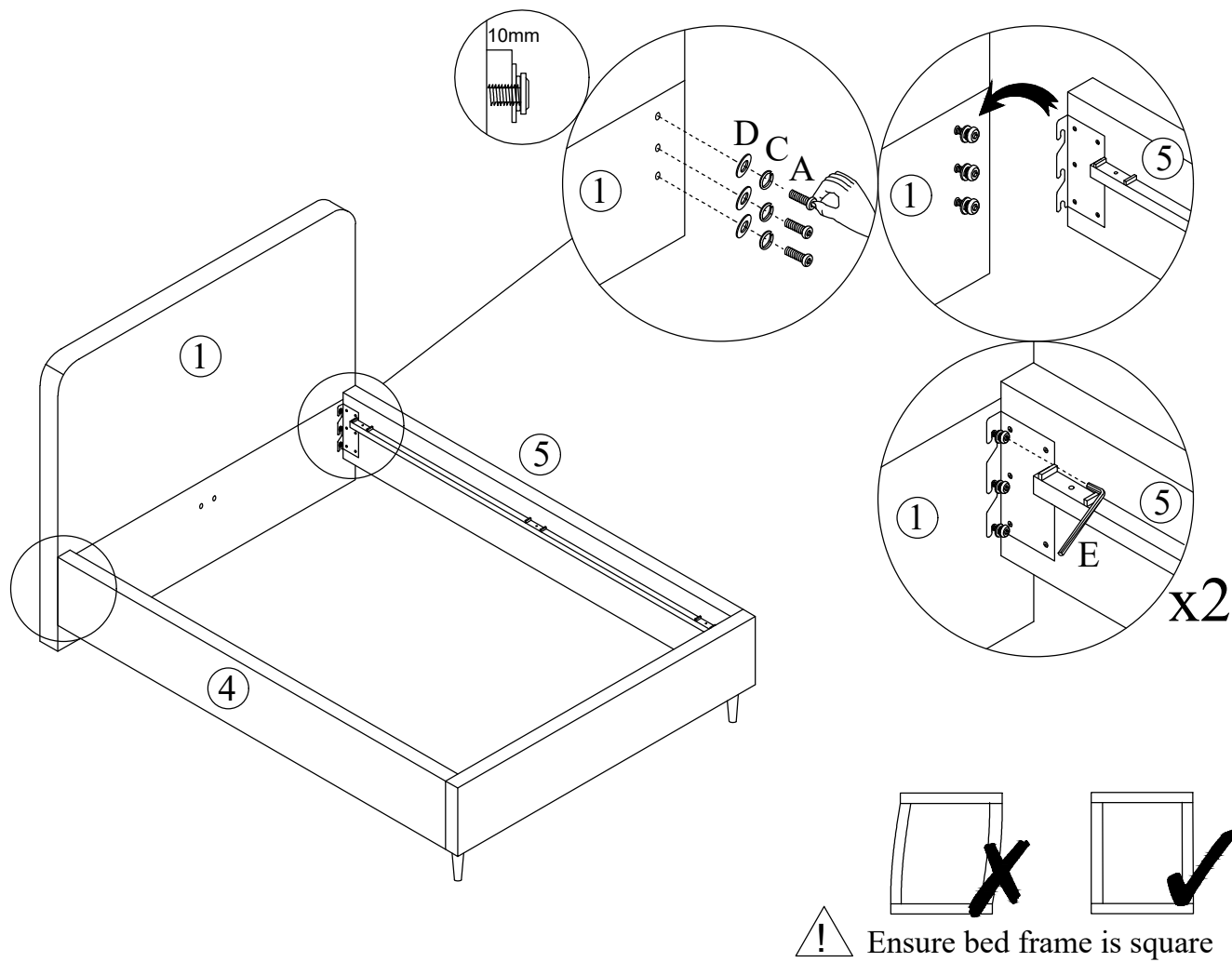

### STEP 4

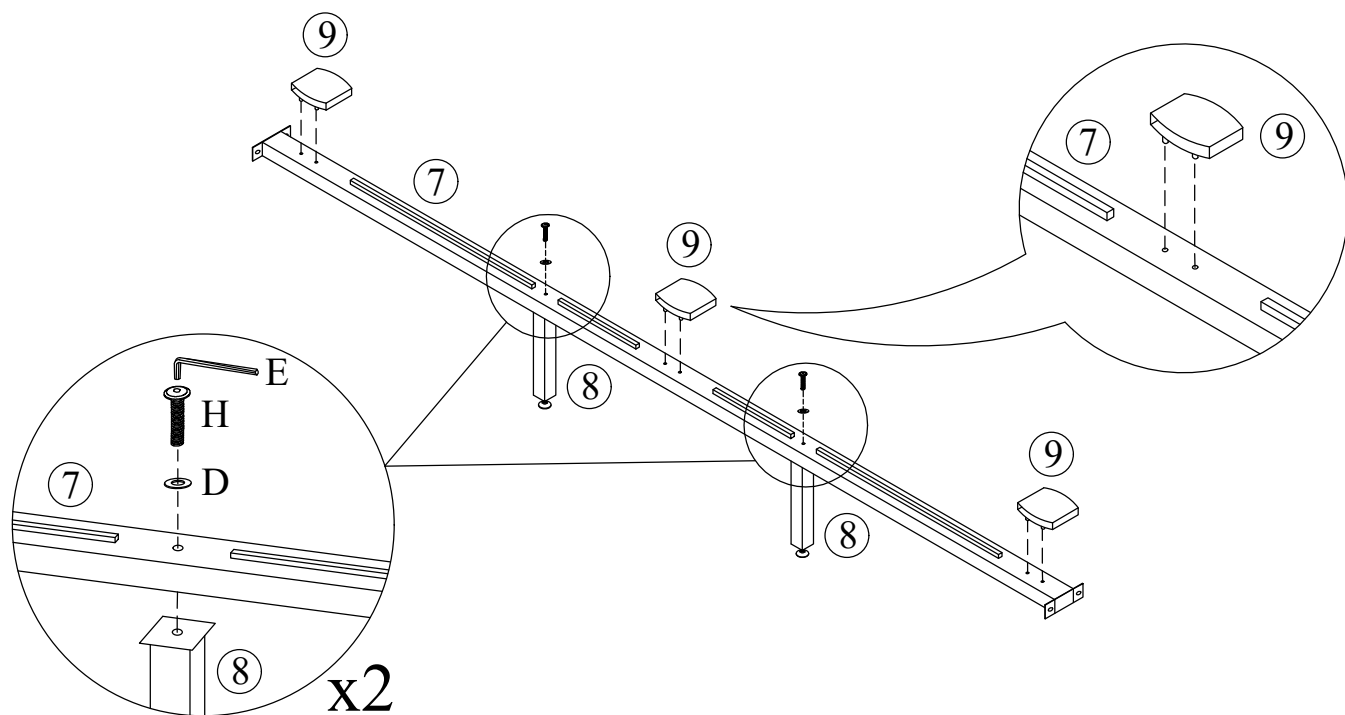

## STEP 5

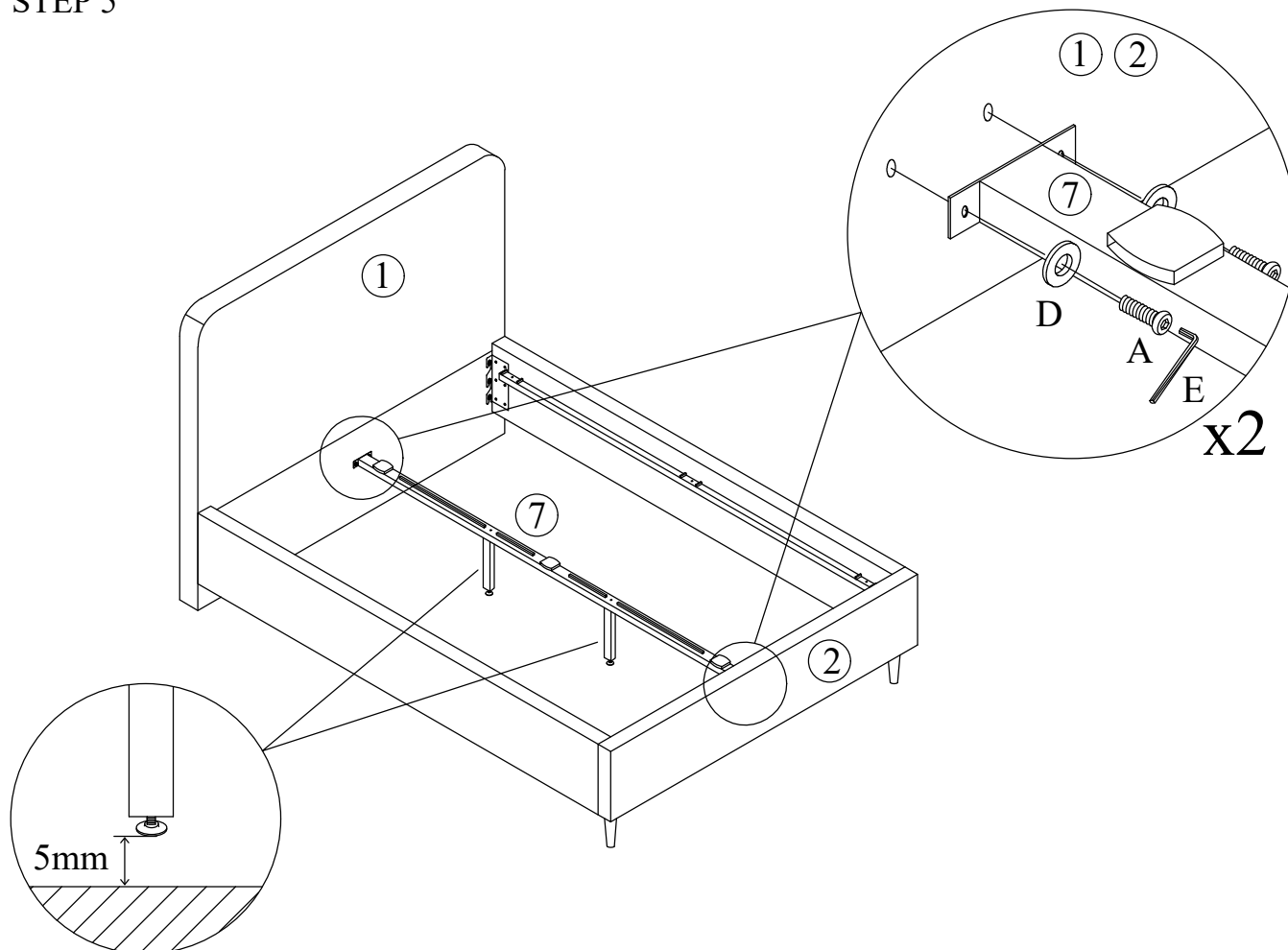

## STEP 6

