

# Assembly instructions

## Base with storage

[90 x 190]

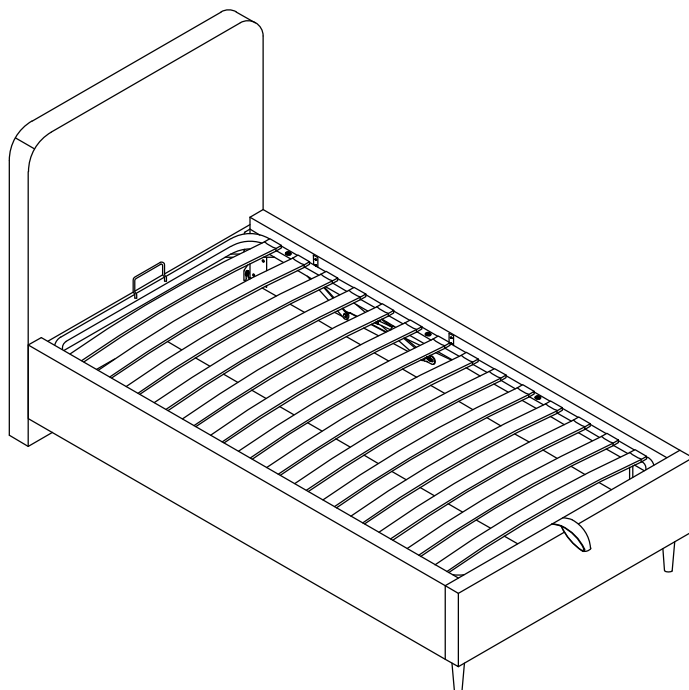

### IMPORTANT

1. PLEASE CHECK THAT ALL PARTS ARE PRESENT BEFORE YOU START THE ASSEMBLY OF YOUR FURNITURE.
2. FOR THE PROTECTION OF YOUR FURNITURE, PLACE ALL PARTS ON A CLEAN AND SMOOTH SURFACE TO PREVENT ANY DAMAGE.
3. PLEASE PERIODICALLY CHECK ALL FITTINGS AND RE-TIGHTEN AS NECESSARY.

## PART LIST

(1) Headboard x 1pc

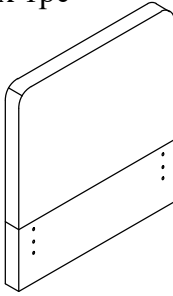

(2) Footboard x 1pc

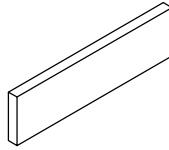

(3) Metal Frame Base x 1pc

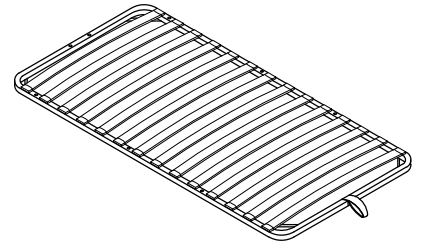

(4) Side Rail (Left) x 1pc

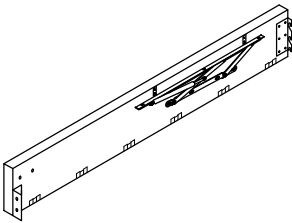

(5) Side Rail (Right) x 1pc

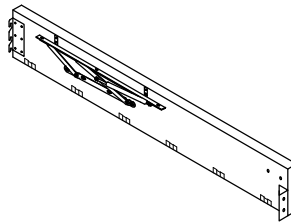

(6) Legs x 2pcs



(7) Wooden Horizontal Support  
x 6pcs

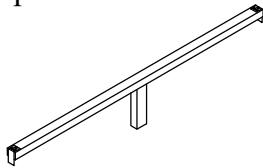

(8) Mattress Stopper x 1pc



(9) Storage Board x 2pcs

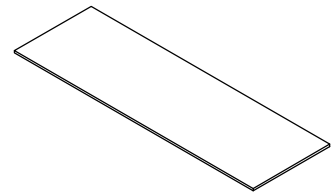

(10) Metal Corner Plate x 2pcs



## HARDWARE LIST

(A) Bolt M8 x 25mm x 18pcs

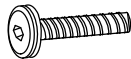

(B) Bolt M8 x 50mm x 6pcs

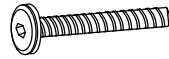

(C) Spring Washer x 26pcs



(D) Flat Washer x 32pcs



(E) Allen Key M5 x 1pc



(F) Spanner x 1pc

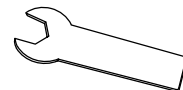

(G) Nut M8 x 13mm x 8pcs



(H) Flange Nut x 2pcs



## STEP 1

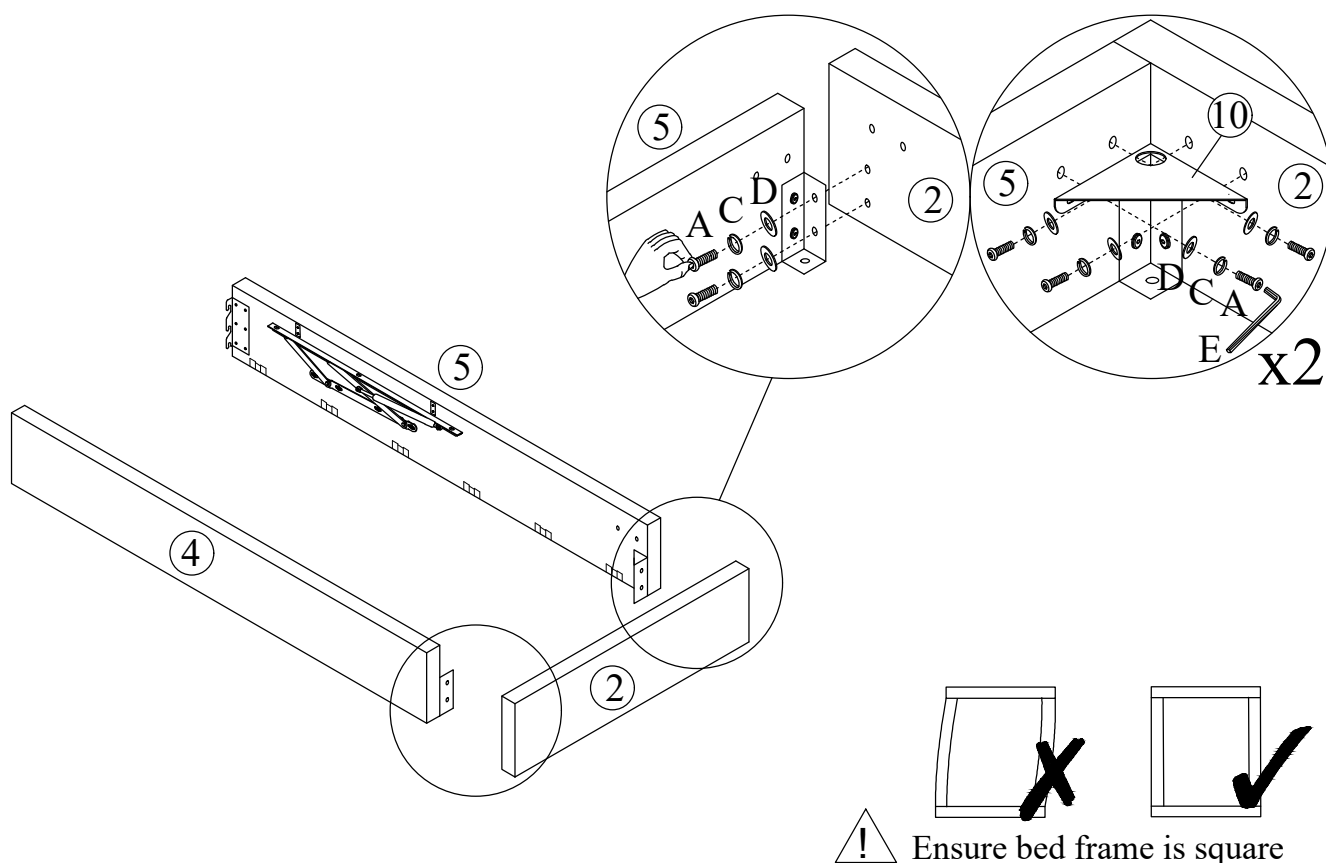

## STEP 2

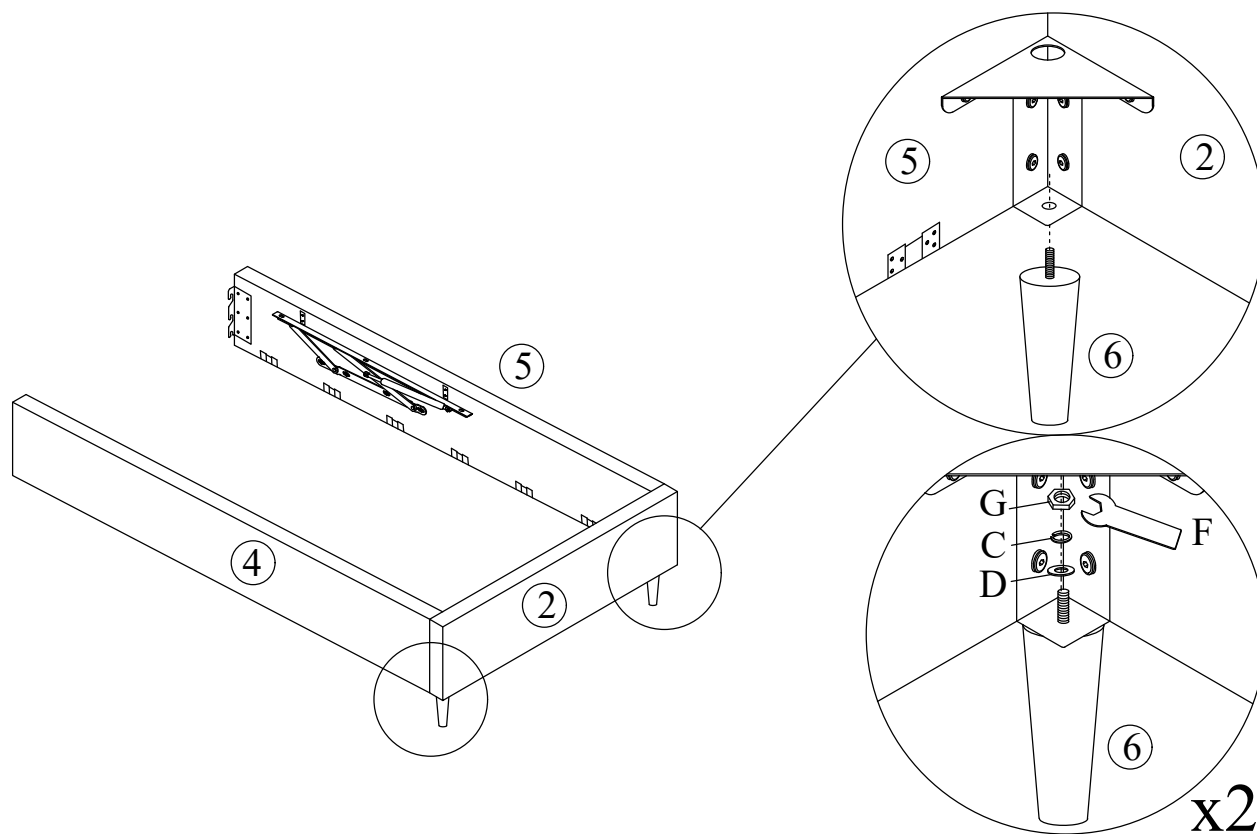

## STEP 3

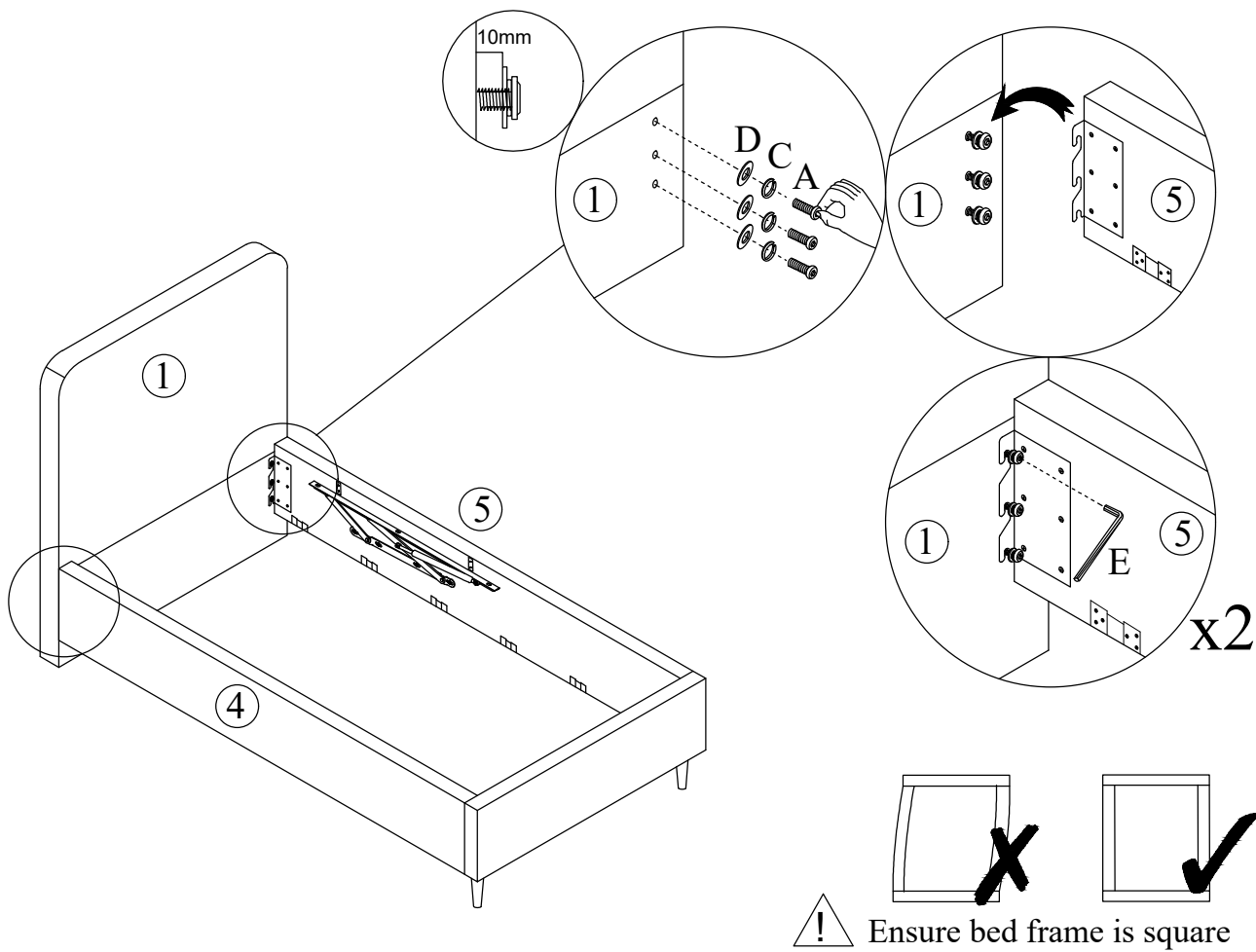

## STEP 4

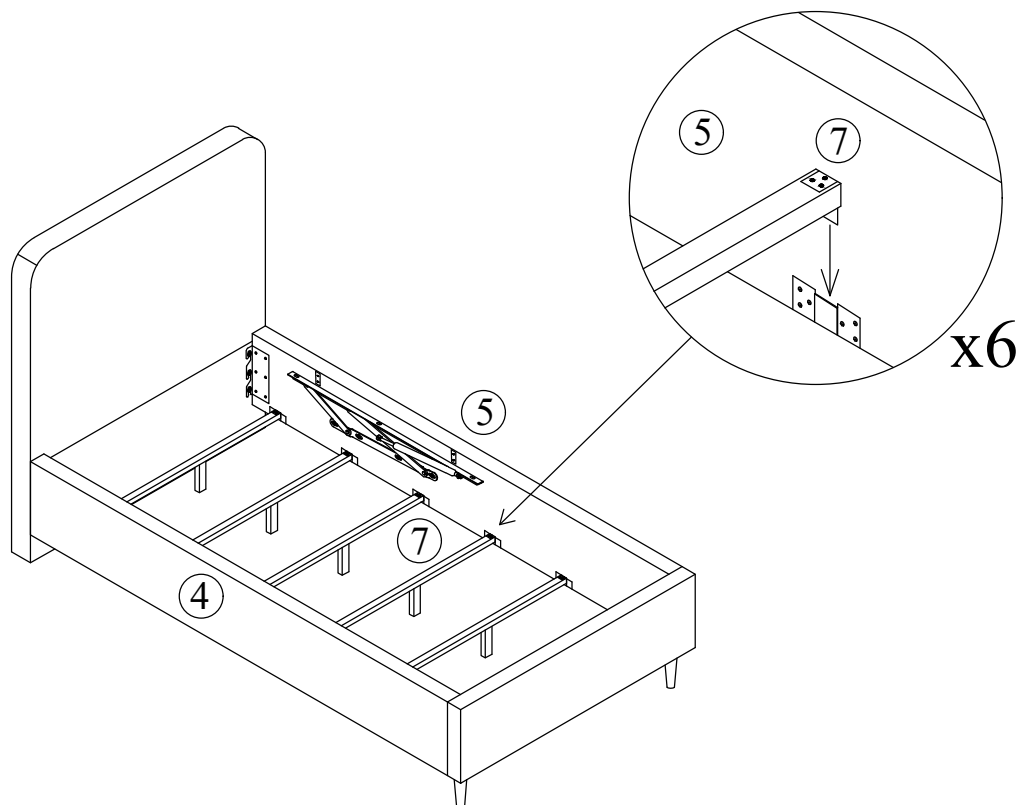

## STEP 5

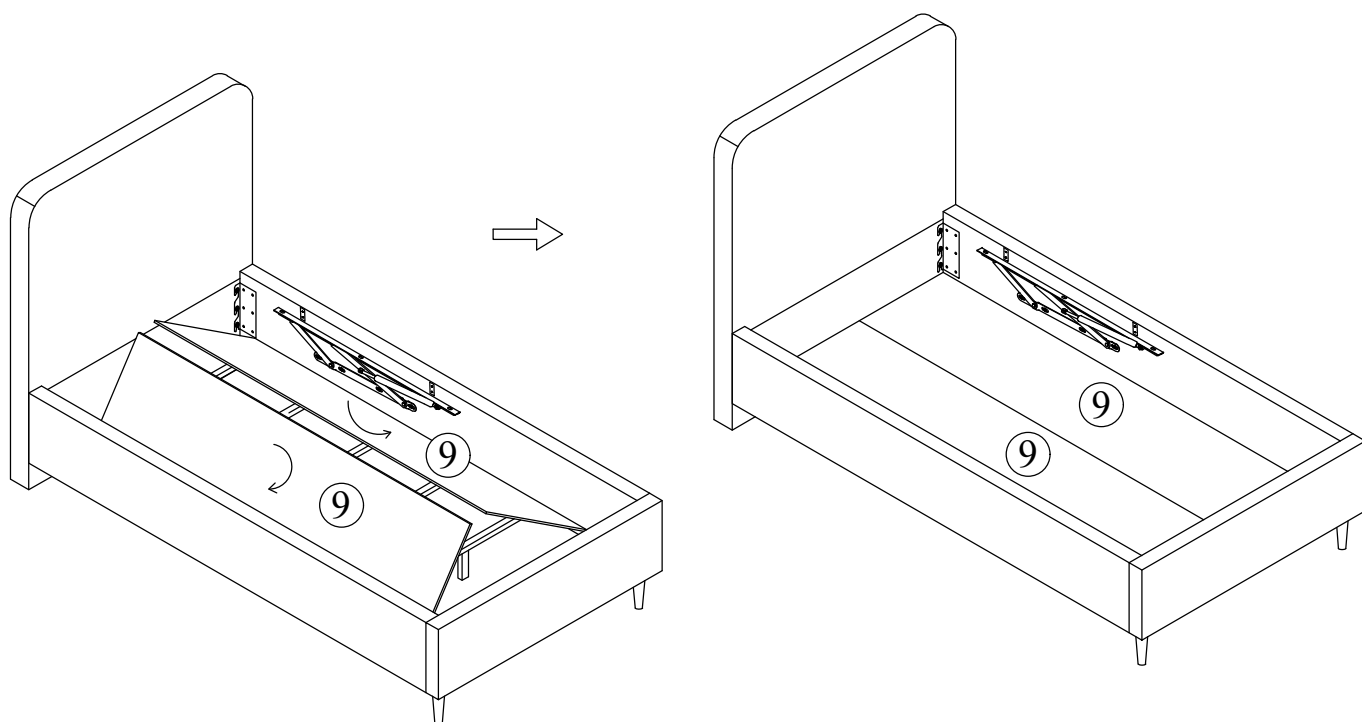

## STEP 6

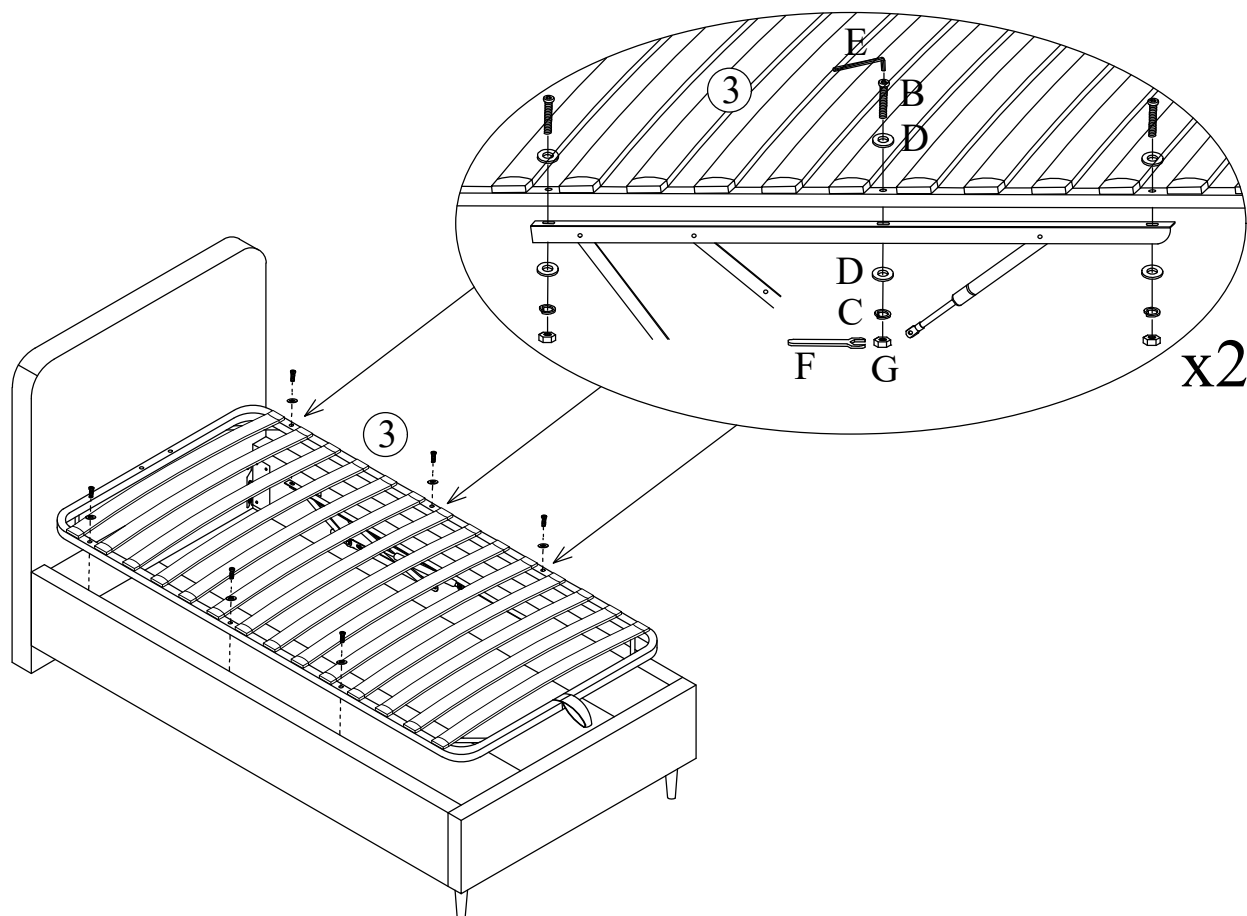

## STEP 7

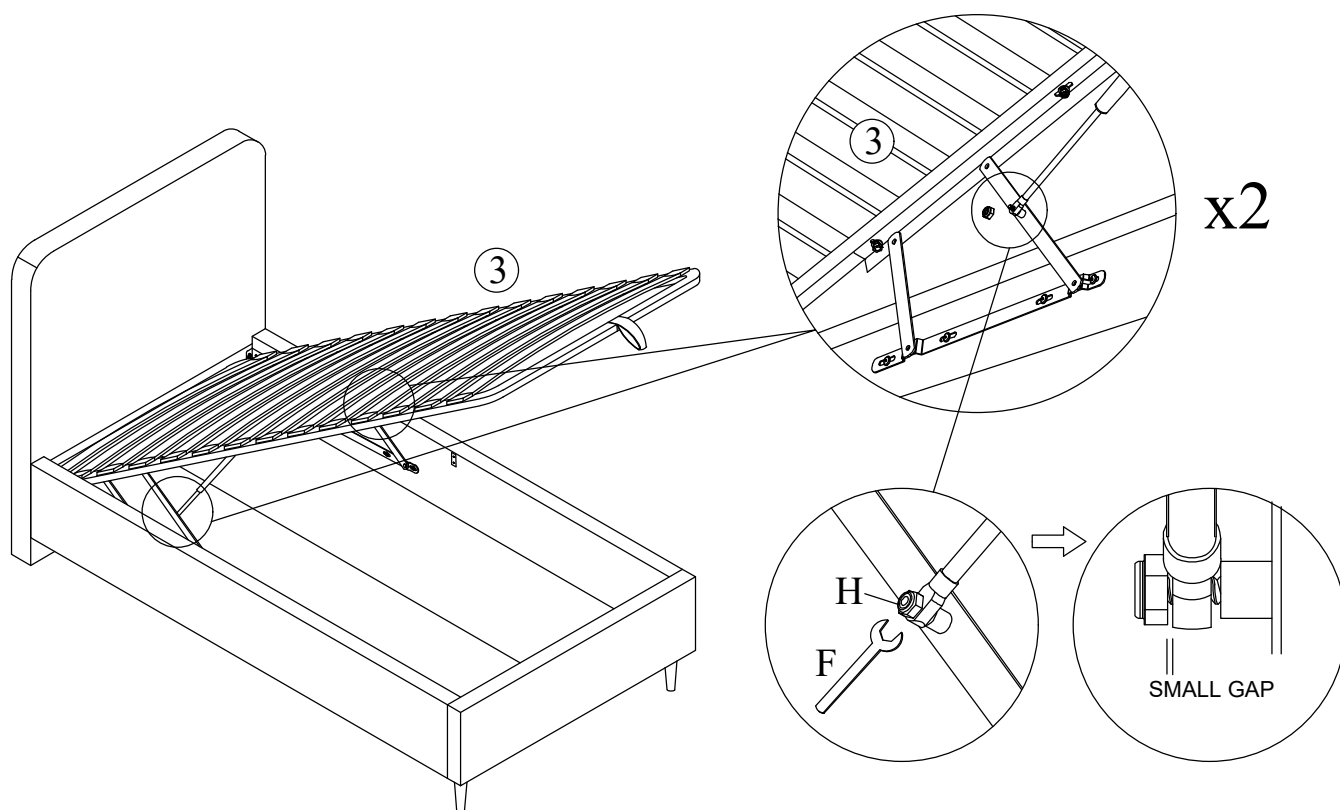

## STEP 8

